

# MODCO-3-10x10

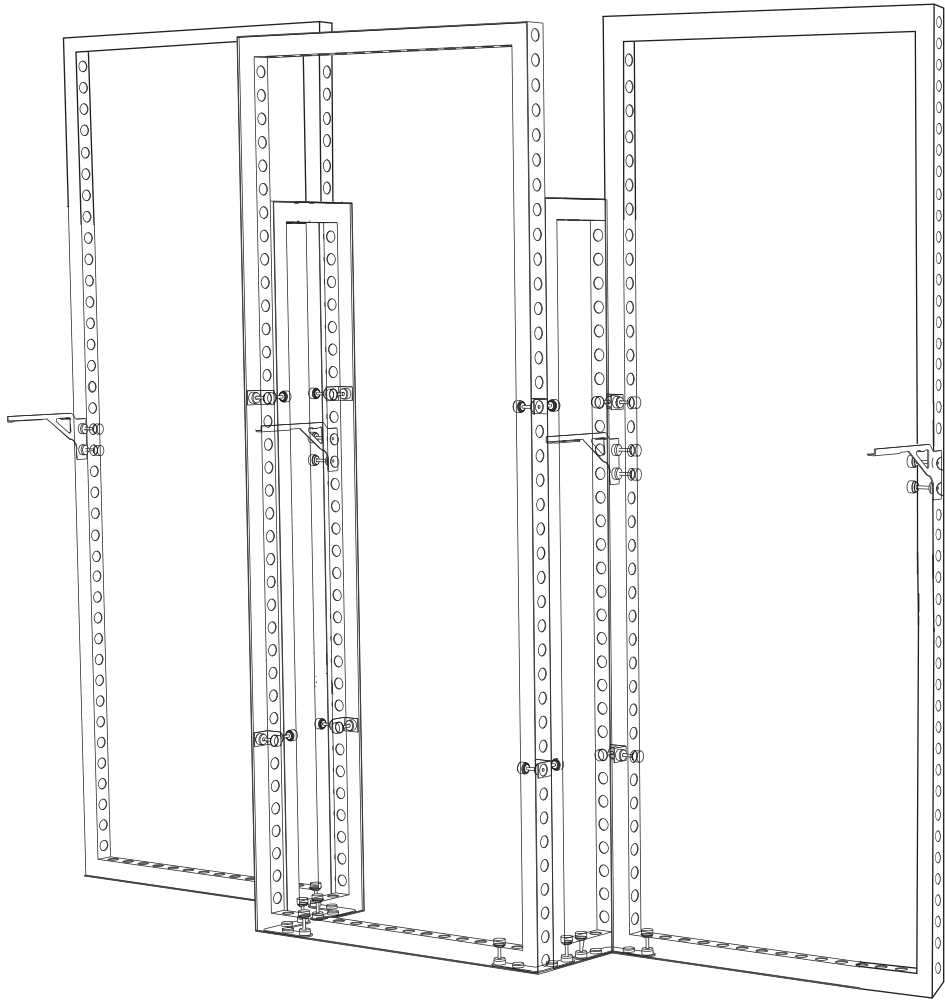

Instructions

## Parts / Frames

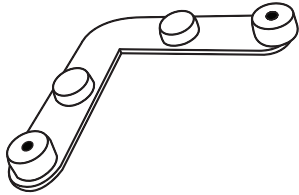

**90° Connector**  
MOD-SM90D-CON  
Qty.4

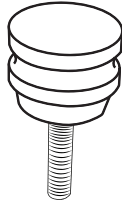

**Pin Connector**  
MOD-PC  
Qty.32

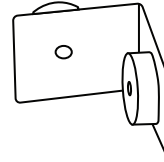

**90° Connector**  
MOD-90D-CON  
Qty.8

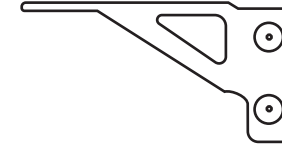

**Shelf Holder**  
MOD-SHELF-KIT-INS  
Qty.2



**310 x 1984**  
MOD-FRM-310x1984  
Qty.2

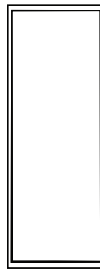

**992 x 2418**  
MOD-FRM-992x2418  
Qty.3



**Counter Shelves**  
MOD-PNL  
Qty.2

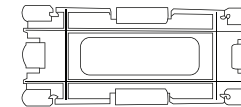

**Clip Connector**  
MOD-CC  
Qty.18

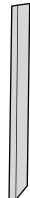

**17" Cover Profile**  
MOD-CP-3100  
Qty.2



**78" Cover Profile**  
MOD-CP-3100  
Qty.2



**95" Cover Profile**  
MOD-CP-3100  
Qty.4

## Connections

# C

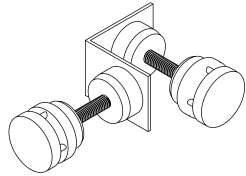

MOD-90D-CON + MOD-PC

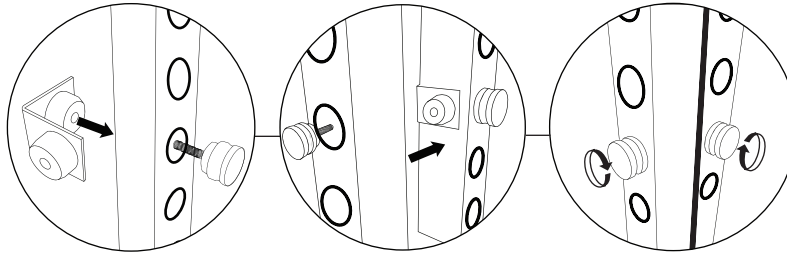

# D

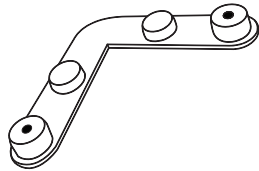

MOD-SM90D-CON / MOD-PC

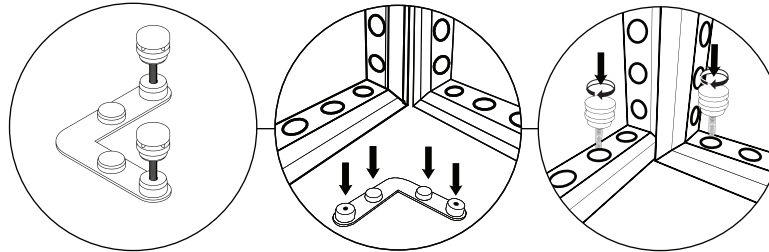

## Cover Profiles

# E

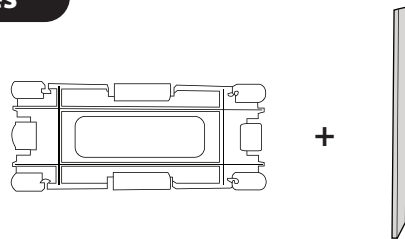

MOD-CC / MOD-CP-3100

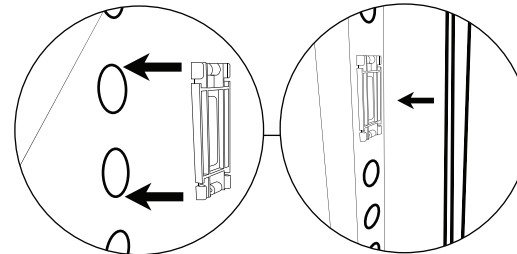

## Shelves

# F

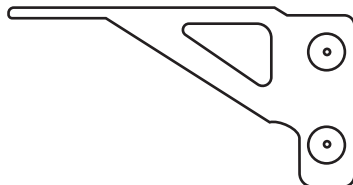

MOD-SHELF-KIT-INS

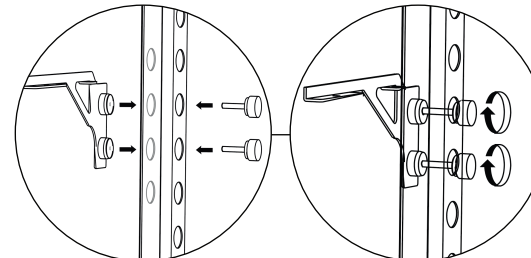

1

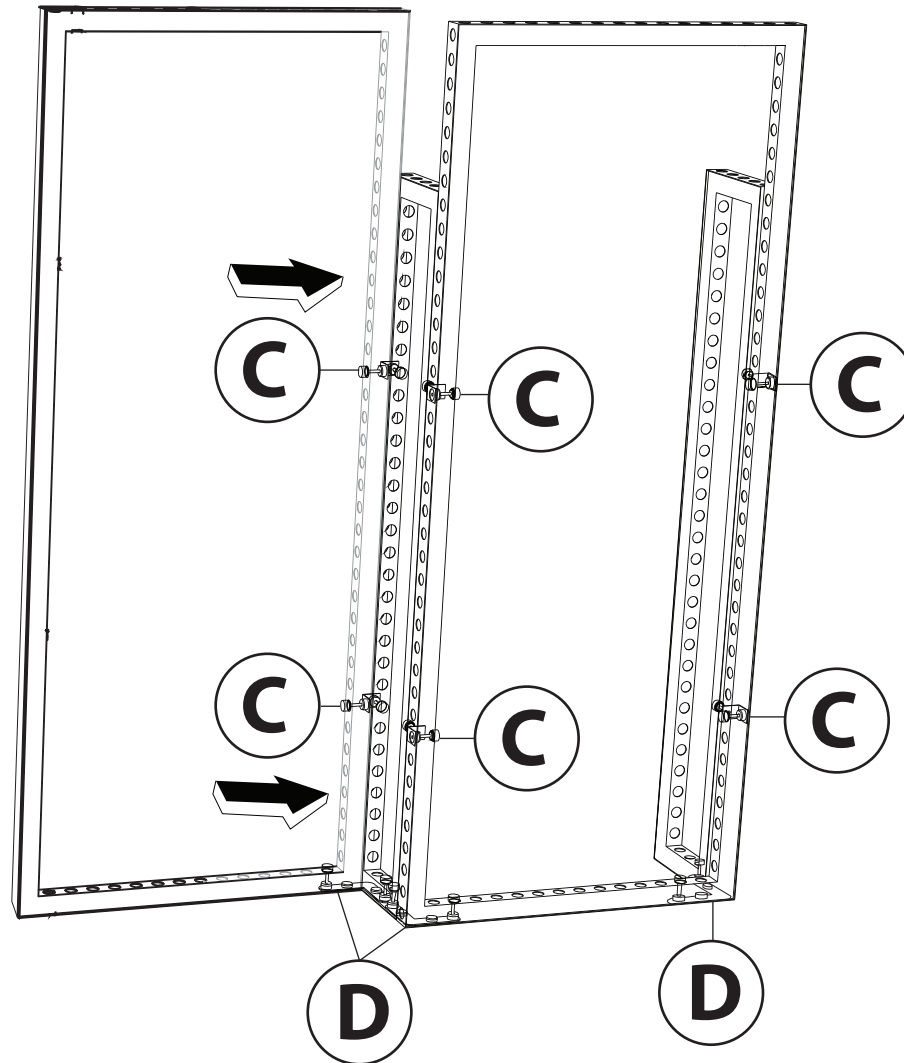

Pre-install graphics on 310x1984 section before connecting.  
(Graphic Install page)

2

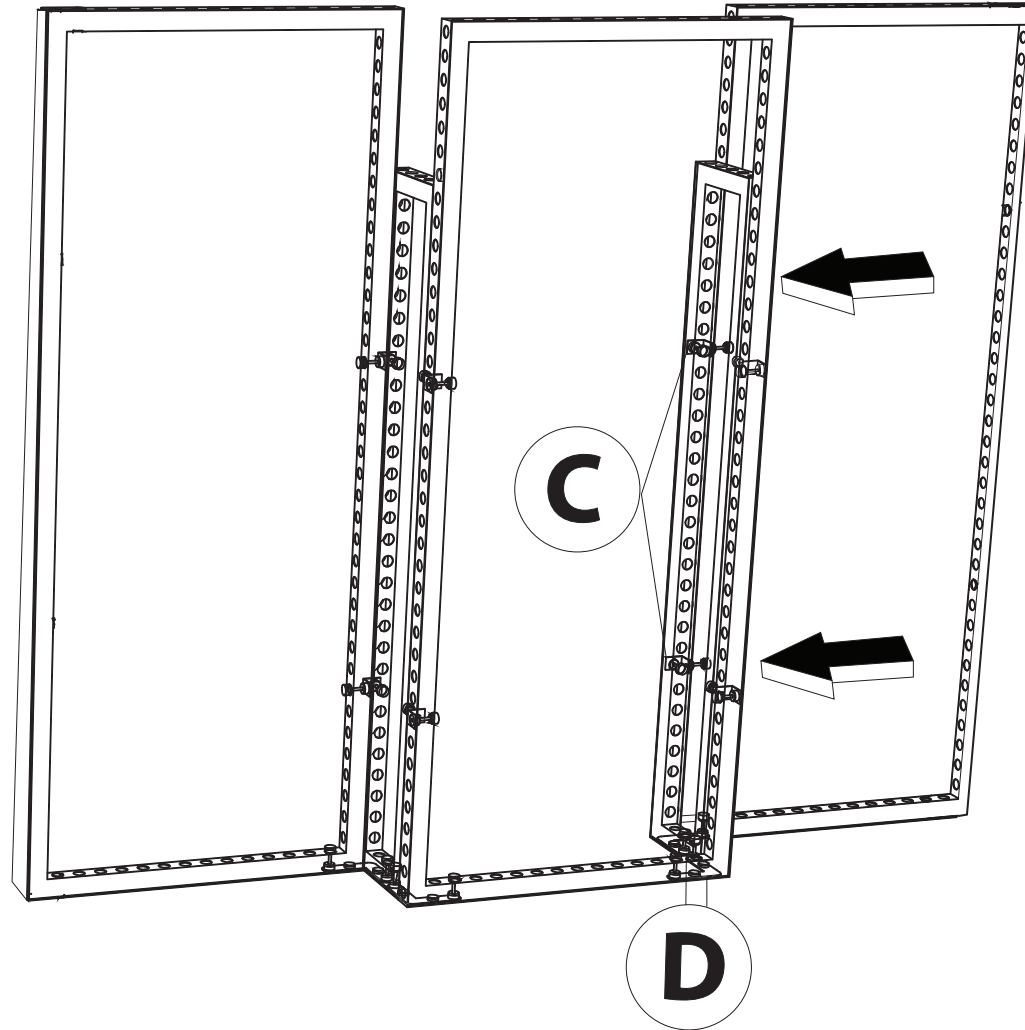

**Pre-install graphics on 310x1984 section before connecting.  
(Graphic Install page)**

## Graphic Install



Place graphic over the front of the frame.



Begin inserting SEG beading at each corner.

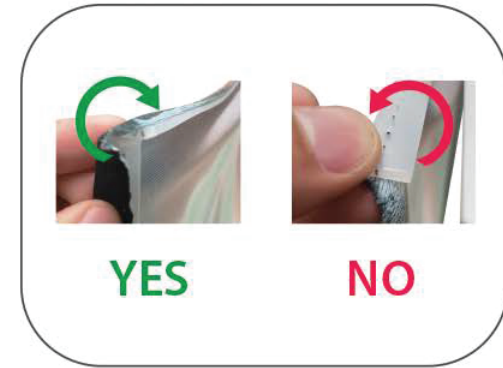

Insert the silicone beading with the fabric folded over. The silicone beading should not be exposed.

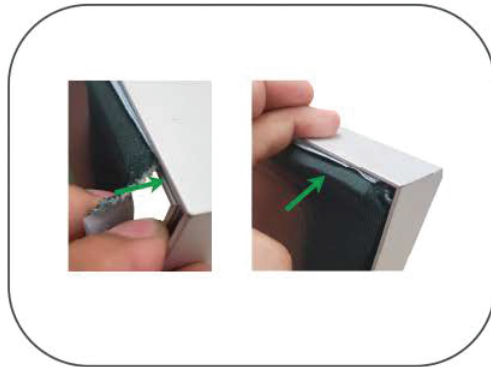

Using your fingers, push both fabric and silicone beading completely into the extrusions channel.

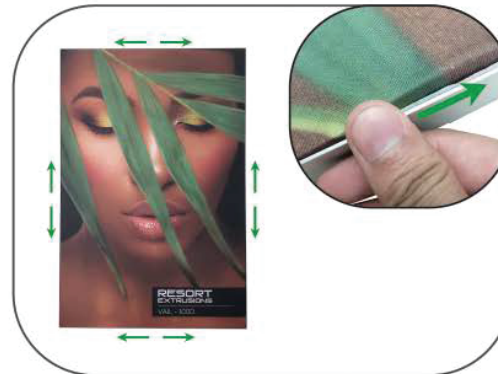

Continue to push in the remaining silicone beading on each side.



Check the perimeter of the frame for any excess beading that hasn't been pushed in. Graphic should be taut.

3

